

Changing the battery on your CS540/W740/W745 headset

- 1) If you have the headset connected to the headband it pays to remove this first for ease of access.
- 2) Slide battery cover down and remove from headset.
- 3) Carefully pull the battery out from the battery compartment
- 4) Unclip the battery from the connector.
- 5) Install the new battery by reversing these previous steps.

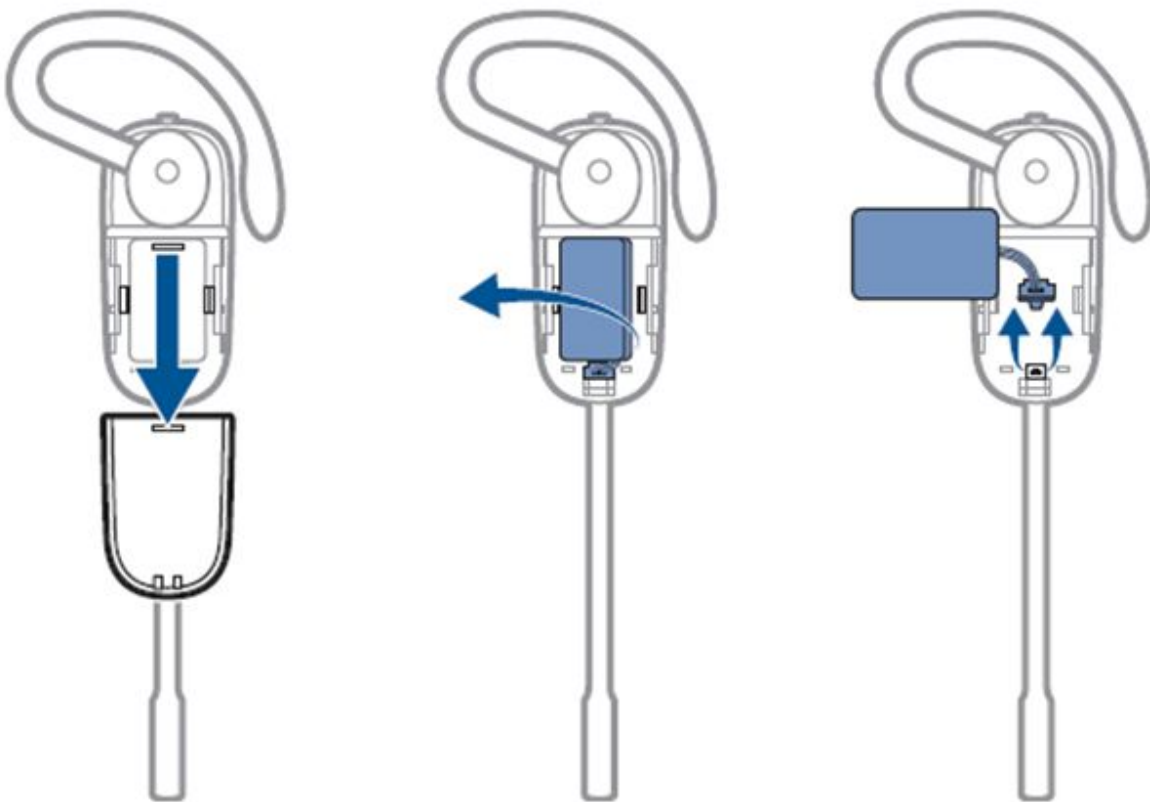

Tried everything and still not working?

Call Our Friendly Experts

1300 889 728

